



2020

Multi Parts Console System



TPCS- 120 - GS

8/25/2020

Product Specifications

Basic material:	ASTM A653 Steel Sheet - Zinc-Coated (Galvanized Steel Sheets).
Material thickness:	Enclosure: 1.5 mm Door and console cover: 2.0 mm Mounting plate: 3.0 mm
Surface finish:	Enclosure, cover and door: Dipping degrease and phosphating then epoxy based powder-coated on the outside and inside, textured paint. Mounting plate: Zinc-plated.
Color:	RAL 7035, RAL 7032
Protection category (IP)	IP 54 with selection of the appropriate gland plates, doors and console cover all-round foamed-in PU seal.
Protection category NEMA:	NEMA 13 with selection of the appropriate gland plates.
IK Code :	IK08
Supply includes:	Enclosure with doors at front with locking rod, blind back cover at rear, fan and double filters at solid sides. Adjustable Mounting plate on depth direction. Cover hinged at rear, 2 stays with automatic locking, manual unlocking on the right and left. Open base for individual cable entry.
Note:	For the double access doors, the base opening is divided in two, and two packs of gland plates.

Product Dimensions

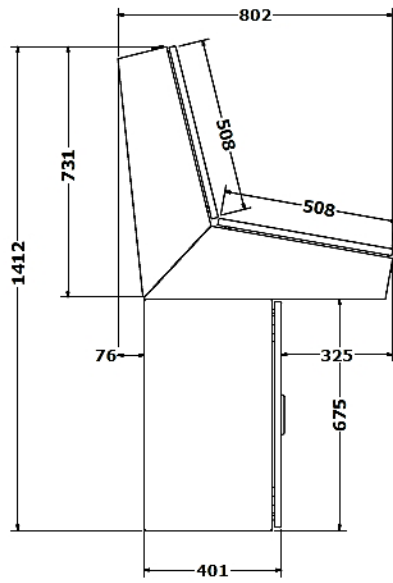

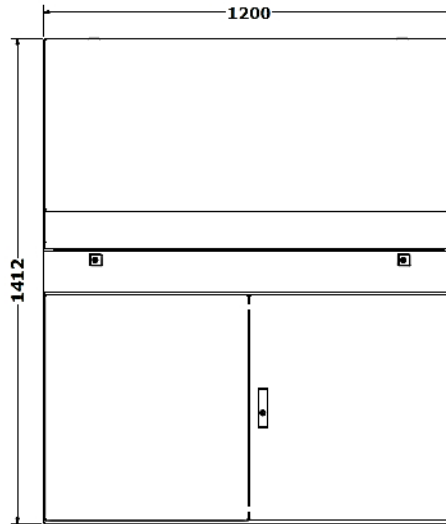

Side View

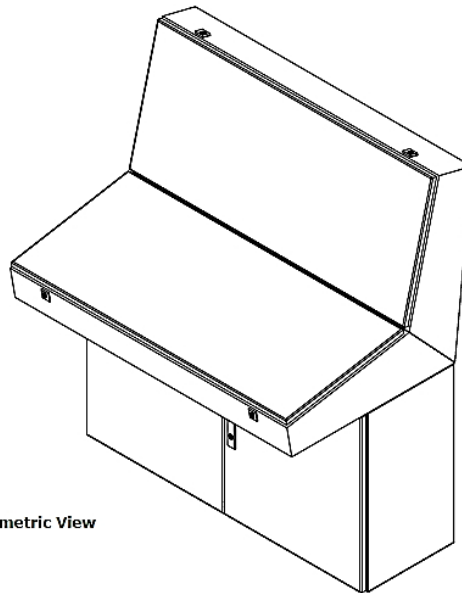

Front View



Isometric View

DRAWN E.Ayman Raslan 20-7-2020 CHECKED D.-E.Ahmed Baslan 20-7-2020 Customer: ABB arab CO. 	 FOR ENGINEERING INDUSTRIES
SIZE D	DWG NO 3-Part TP-Console System
SCALE	REV

Product Details

Outside View



Inside View



Accessories Details

ACCESSORIES

COVER STAY

179



- Stainless steel version: page 521
- Cover Stay with automatic lock to keep the door open
- LH and RH application is possible

MATERIAL
Steel
FINISH
Zinc plated

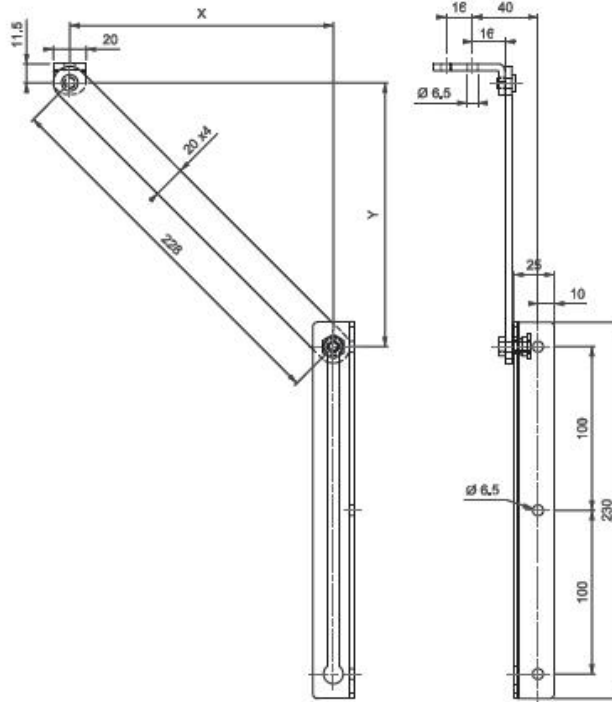

Installation dimensions

OPENING ANGLE	DIMENSIONS		MINIMAL DOOR WIDTH
	X	Y	
90°	140	180	405
105°	120	166	390
120°	110	150	375
135°	100	146	370

For other configurations:
 $y = X + \text{min.} 40$

PRODUCT CODE

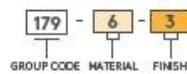

CONCEALED HINGES

CONCEALED HINGE

995

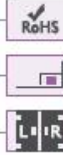

- Stainless Steel version: page: 495
- Side part can be mounted with M5 screws
- Centre part copper plated for easy welding
- Suitable for heavy-duty applications
- Suitable for 25 mm bend door cabinets

MATERIAL
Steel

FINISH
BODY: Zinc plated
WELDING PART: Copper plated

▲ Note: Bolts are not supplied

Stud version

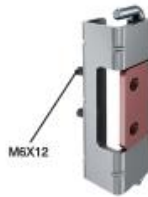

Hinge Rotation Angle



▲ Note: Nuts are not supplied

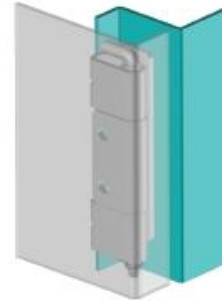
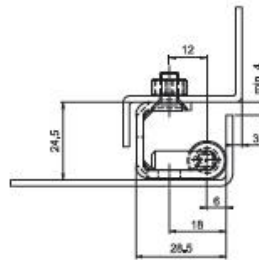
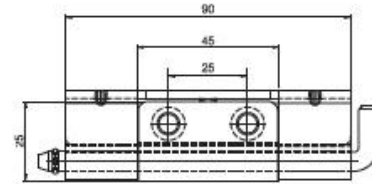
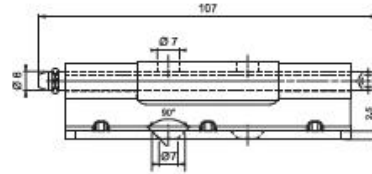

Fixed by clips

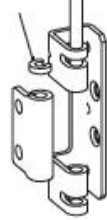

V : 4

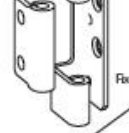

Fixed by O'ring

V : 3

Middle Parts

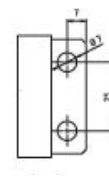

MP :1

Circle

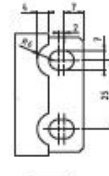

MP

Slot

PRODUCT CODE

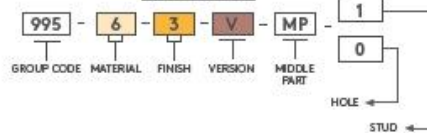

▶ QUARTER-TURN LOCKS

QUARTER-TURN LOCK

103

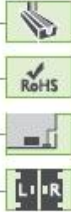

MATERIAL
BODY: PA6 GFR 30
DRIVER: Zamak DIN-EN 1774-ZnAl4Cu1 or PA6 GFR 30
CAM: Steel
GASKET: Polyurethane

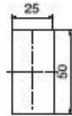

Cut Out

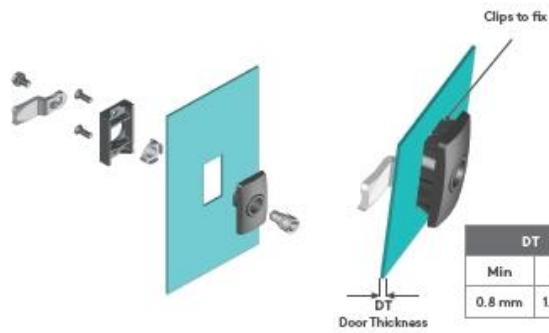
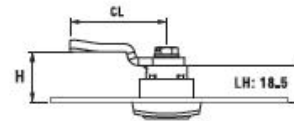
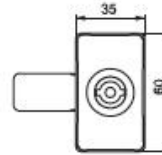
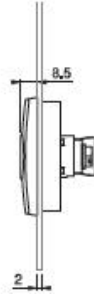

DT	
Min	Max
0.8 mm	1.8 mm

V : 1

V : 6

Clips to fix

PRODUCT CODE

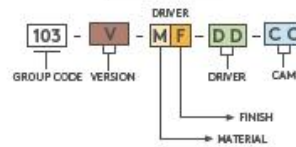

For cams please check pages: 170 - 171
 For drivers please check page: 194
 For keys please check pages: 189 - 191

ROD-LATCH SYSTEM

THREE-POINT LOCK

203

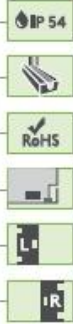

- Clip fixing for easy assembly
- Integral gear-box for three-point locking

MATERIAL
 BODY: PA6 GFR 30
 MECHANISM: Zamak DIN-EN 1774-ZnAl4Cu1
 CAM: Steel
 SEAL: Polyurethane

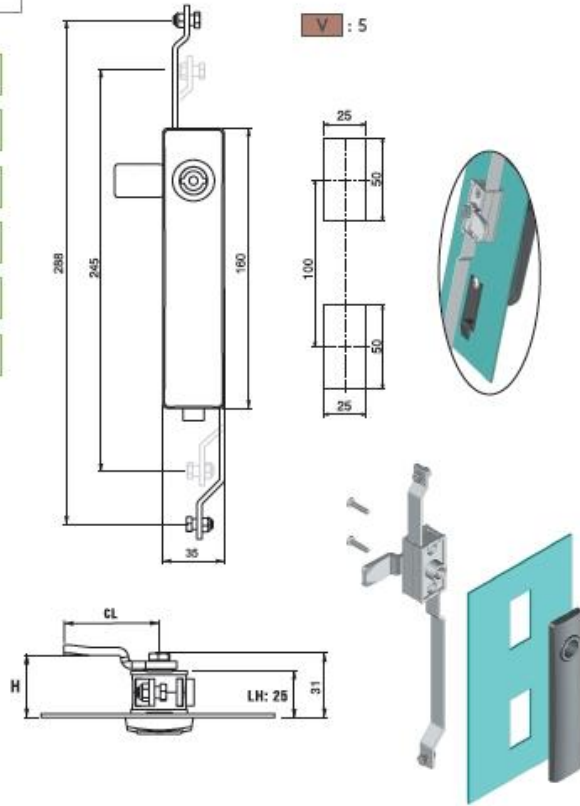

PRODUCT CODE

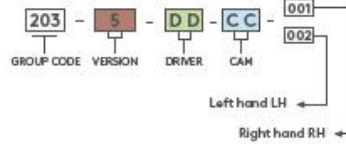

DRIVERS

3 mm Double bit	5 mm Square	9 mm Triangular
15	28	39

- For cams please check pages: 072 - 173
- For rods please check pages: 078 - 188
- For keys please check pages: 189 - 191